

# **SOLARMAN Smart User Version APP**

## **Instruction Manual**

When you need to achieve remote control on APP, you can find how to use the APP and how to operate and adjust the settings of the inverter in this manual.

**1. Download & Use The APP** **1-12**

---

**2. Common Settings** **13-18**

---

# Download & Use The APP

## 1. Install

Search for "SOLARMAN Smart" in the APP store to download and install, or scan the QR code below to download and install.

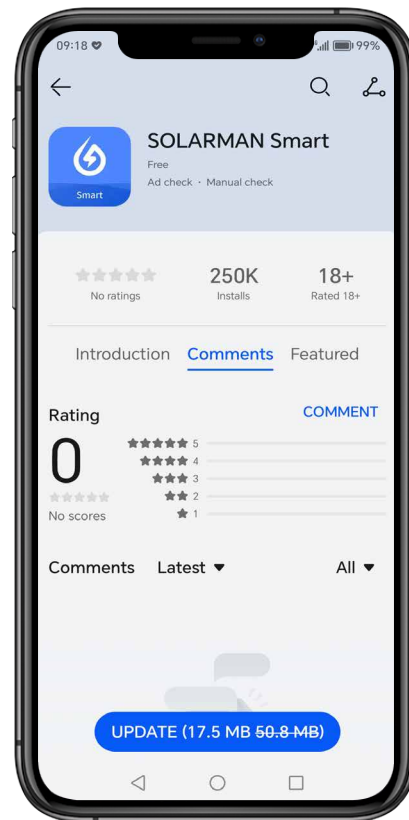
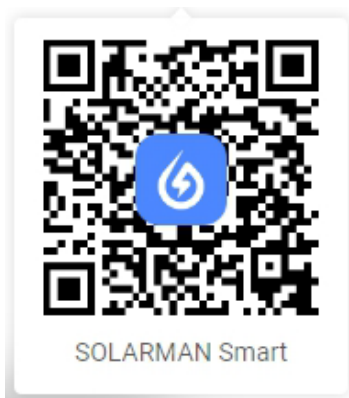

## 2. User Registration

There are two ways to register: email registration and mobile phone number registration. Enter your mobile phone number or email account number, get the corresponding SMS verification code, set a password yourself, and click "I have read and agreed to accept T&Cs and Privacy Policy" and "Done" to complete the registration.

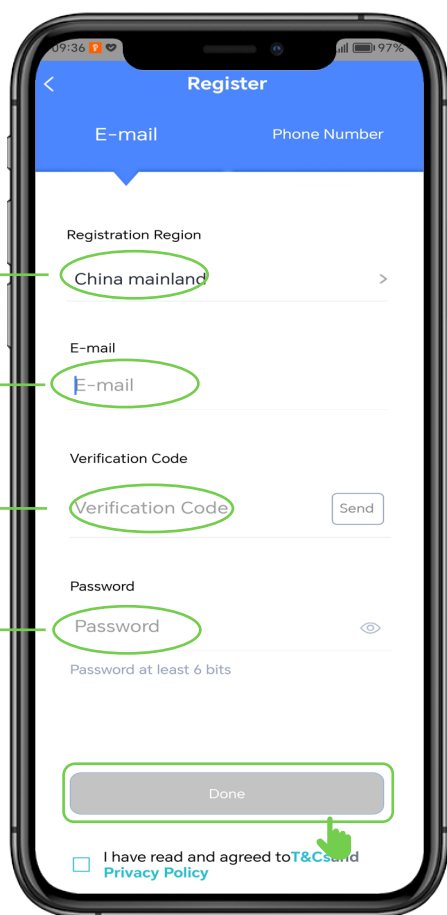

Enter area

Enter your email account

Enter pin number

Enter the password you set

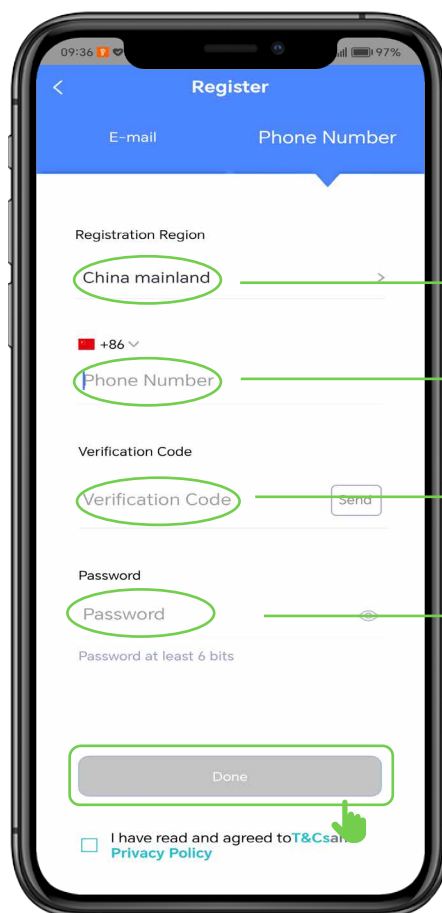

Enter area

Enter phone number

Enter pin number

Enter the password you set

### 3. Create a Plant

After successful login, enter the main interface, please click the "Add Now" button to enter the add power station interface. Please choose whether the installer is responsible for the post operation and maintenance of the power plant according to the actual situation.

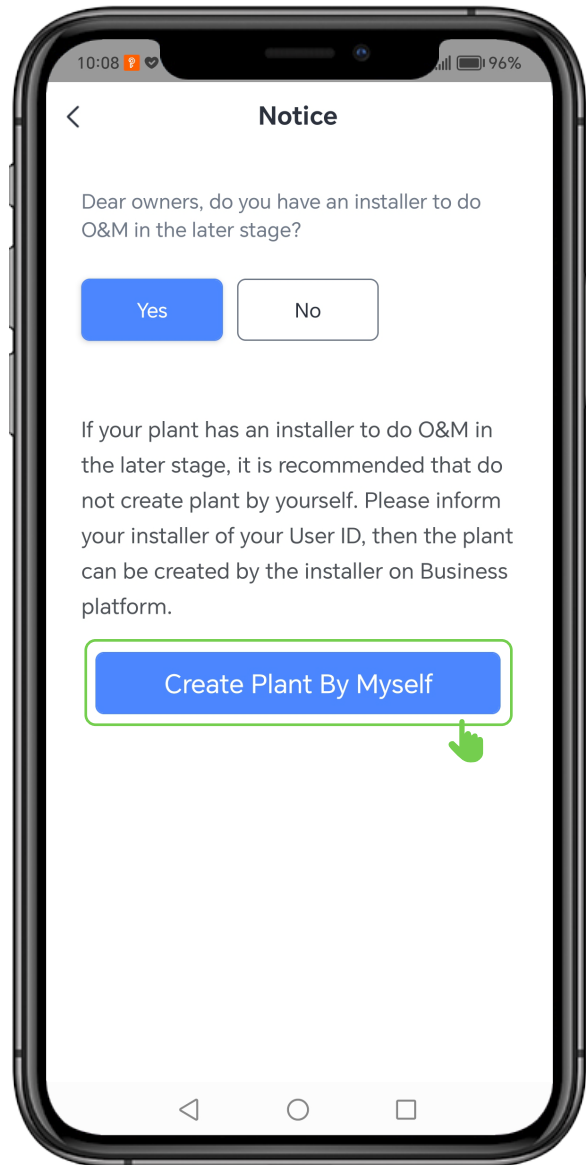
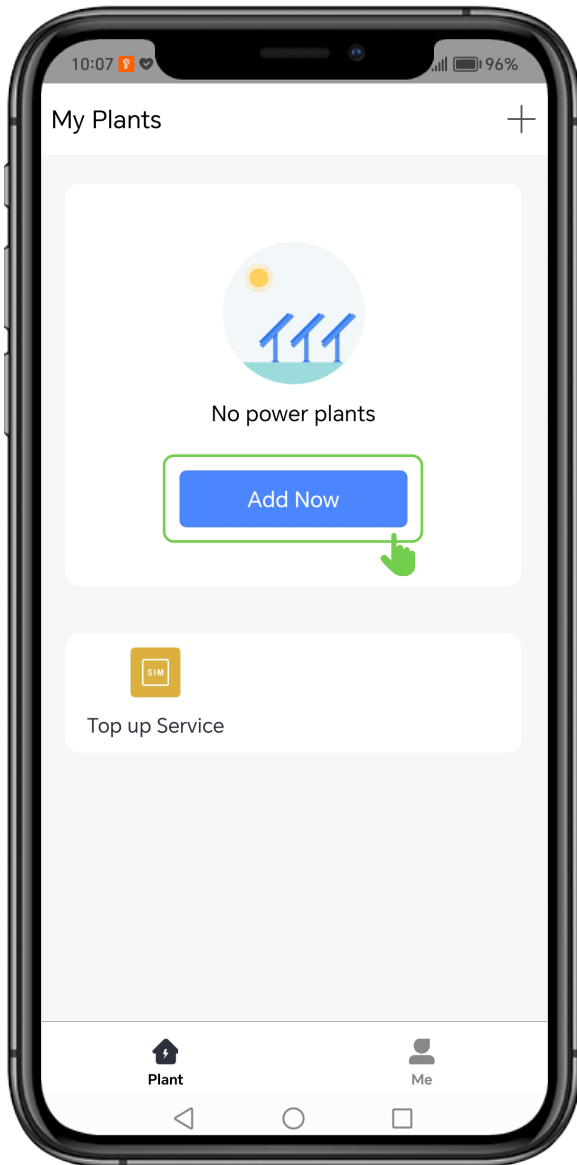

The system will automatically start positioning to confirm the location of the power station. If the address positioning is not accurate, you can choose to select the location by yourself.

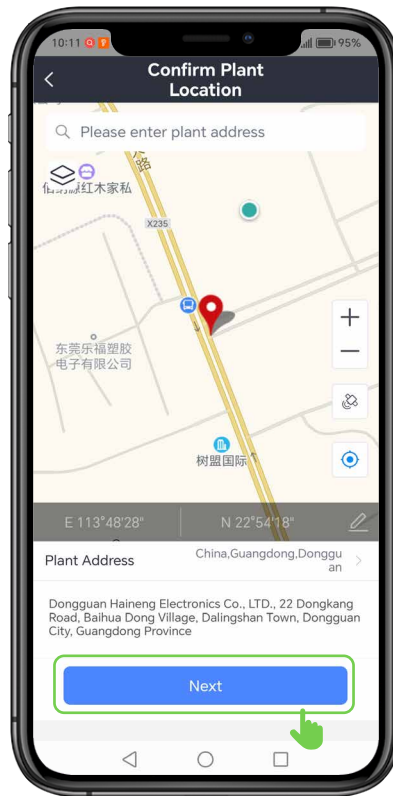

After selecting the location of the power station, enter the power station information. Please fill in according to your equipment information, and consult the installer if you have any questions. Take the 6KW Single-Phase Hybrid Solar Inverter as an example. First, give the power station a name, and then select "energy storage system" as the grid-connected type, fill in "6" for the installed capacity according to the model. Fill in the income information according to the local electricity fee, and click "Done" to create the information.

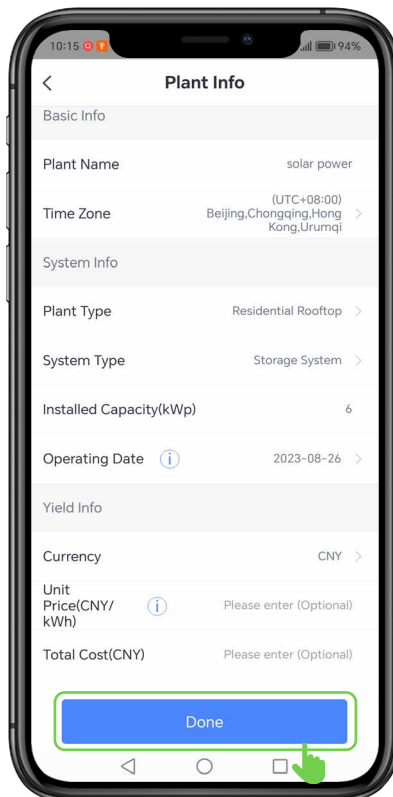

## 4. Add a logger

After completing the creation, a successful creation interface will appear, we can click "Go to Add" to add a logger.

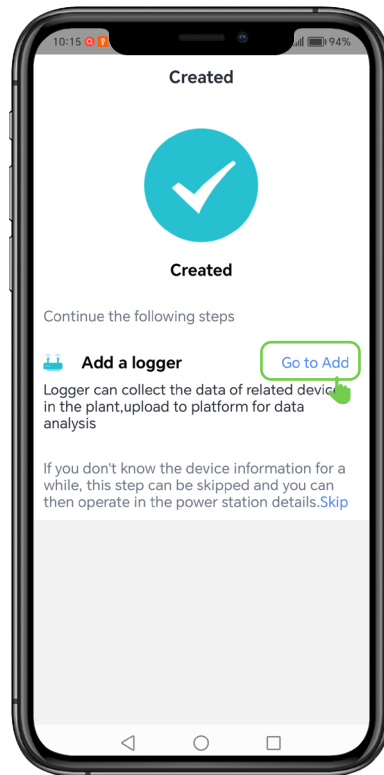

As shown in the figure, you can enter the serial number of your logger in the serial number input box, or click on the scan code on the right side of the input box to add your logger by scanning the code. The serial number and QR code of your logger are printed on the front of your logger device.



Click the Add button when you have finished entering the scan code or serial number to enter the page of selecting related equipment. Please choose "Auto-selection" and click "Done".

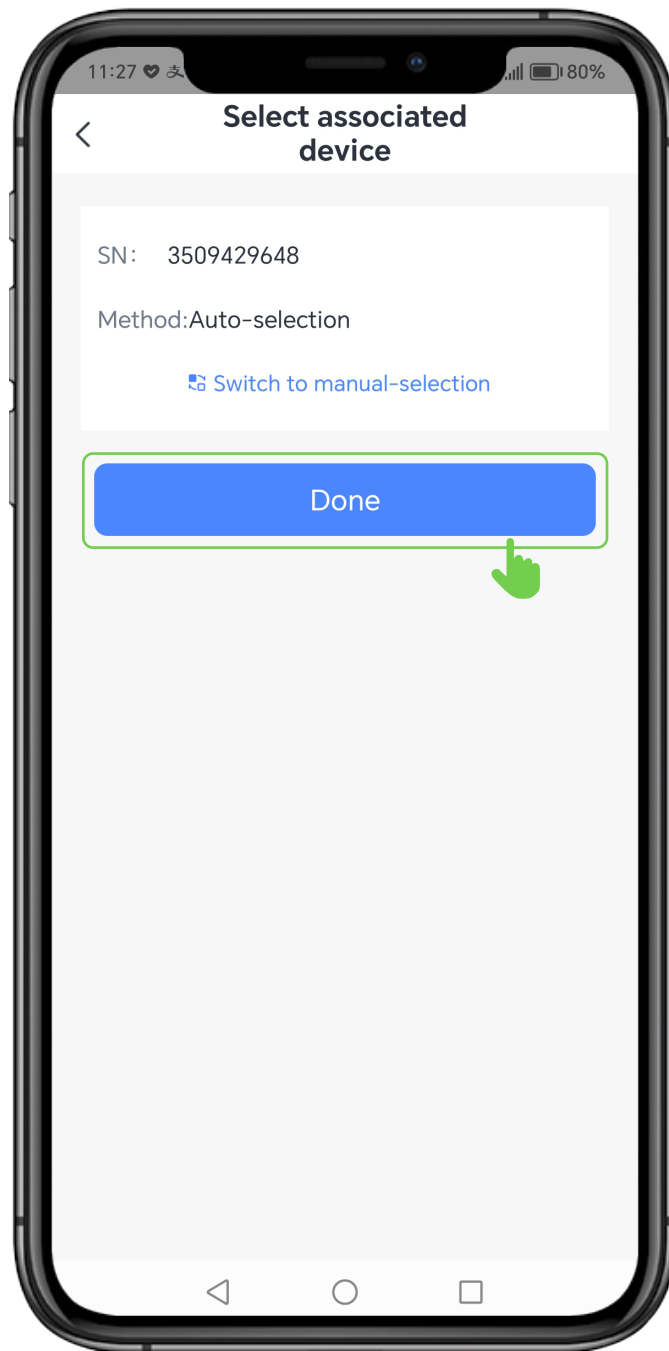

# 5. Device networking

After adding the logger successfully, the prompt of adding the logger successfully will pop up. You can choose "Go to Configure" to configure the network for the logger.

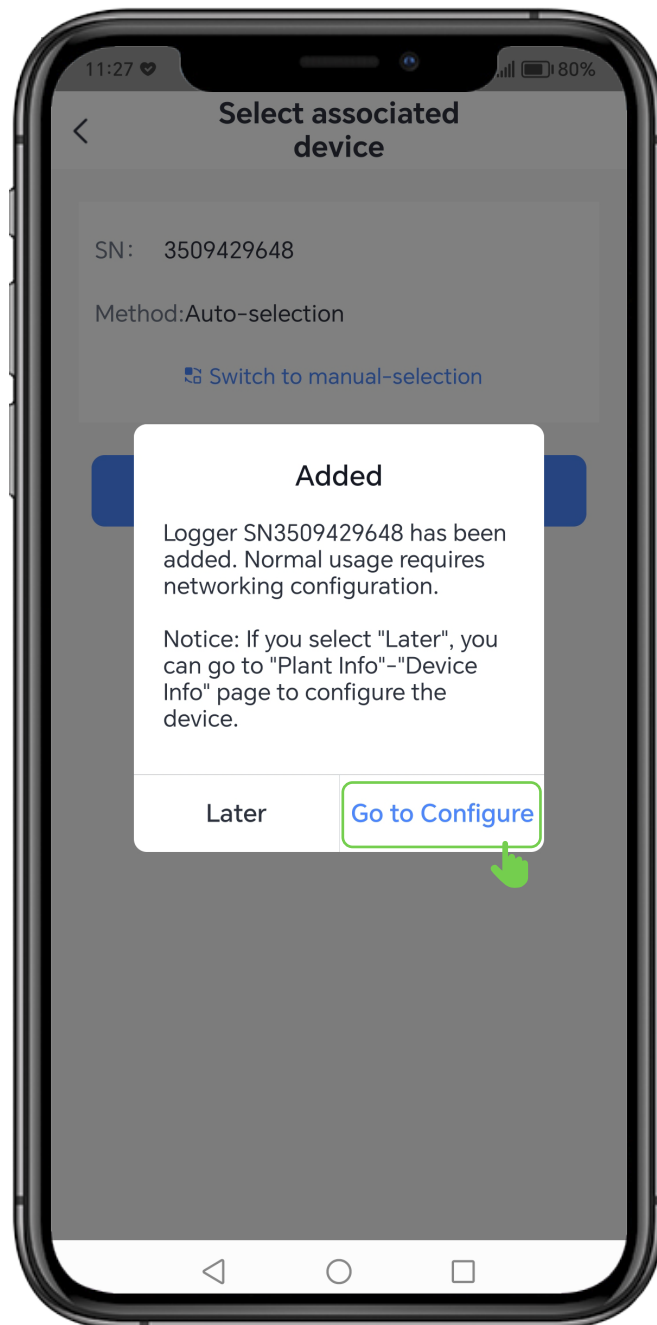

Before network configuration, you need to connect WIFI and turn on the Bluetooth function according to the prompts. If there is no shared WIFI in your area, you can turn on the hotspot on your mobile phone to link the logger with WIFI.

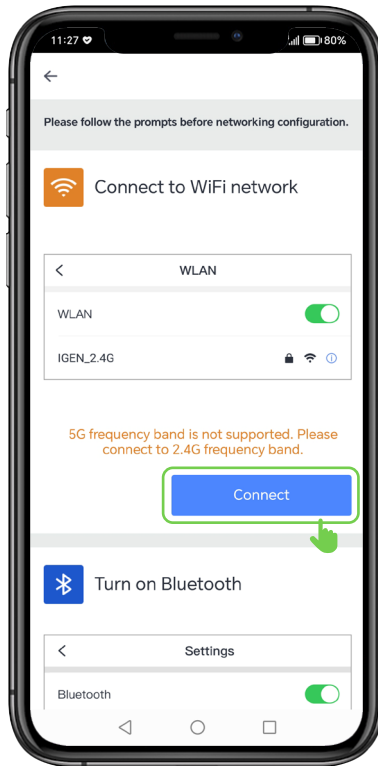

After turning on the Bluetooth and connecting WIFI successfully, you will enter the following interface. Enter the password to confirm that there are no errors. Click "Start to configure" to enter the interface of Device Configuration. Please wait patiently.

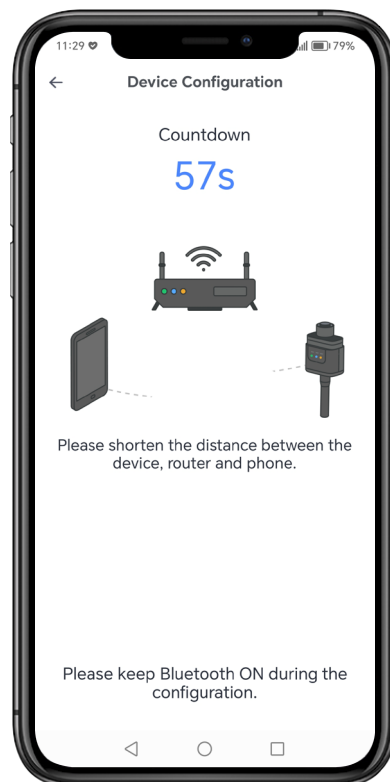

Configuration succeeded.

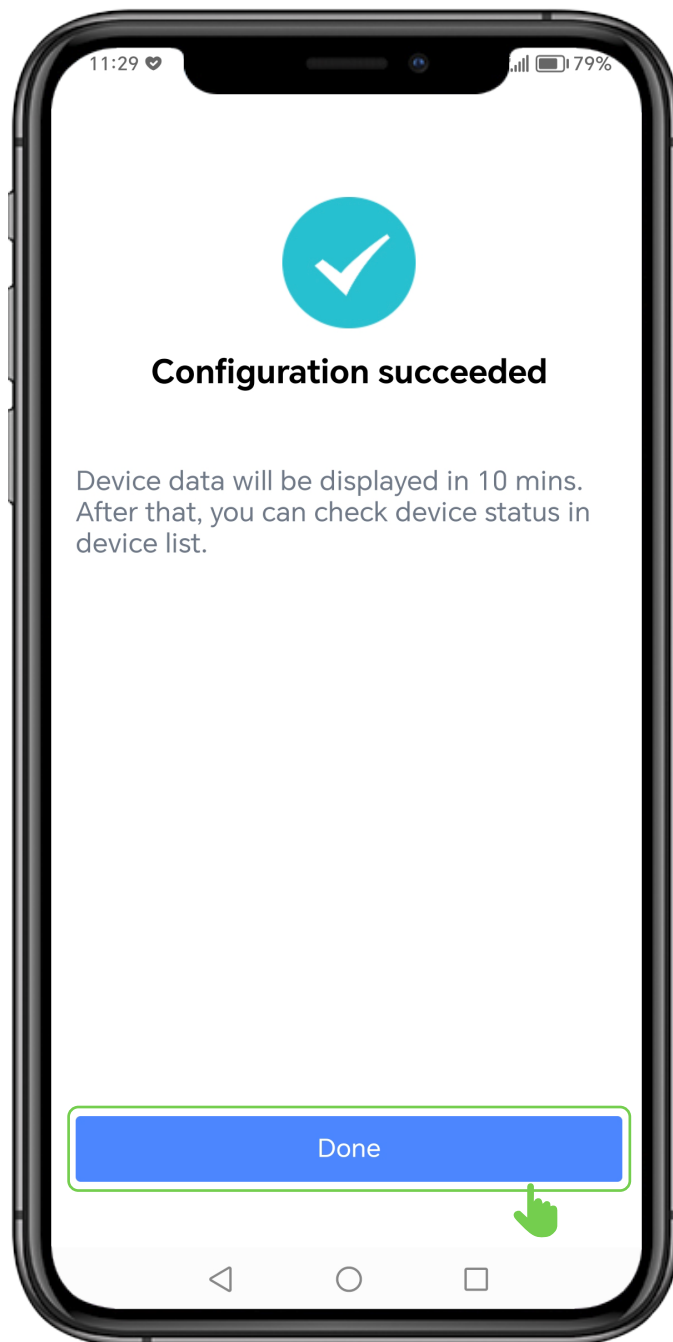

Click "Done" and we will go to the home page.

# 6. Observe the running status of the device

After the power plant is built and the logger is successfully added, the working status of the energy storage system can be seen in real time. In "Real Time", you can see working status of the energy storage system and the statistics of the generated power and discharging power in a day.

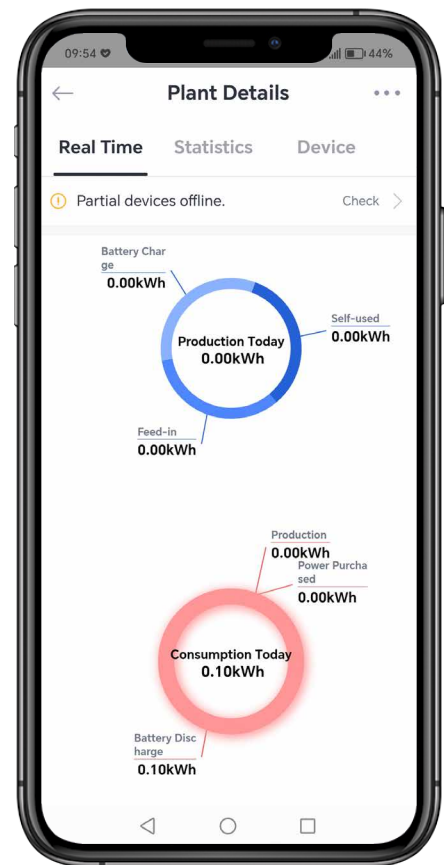
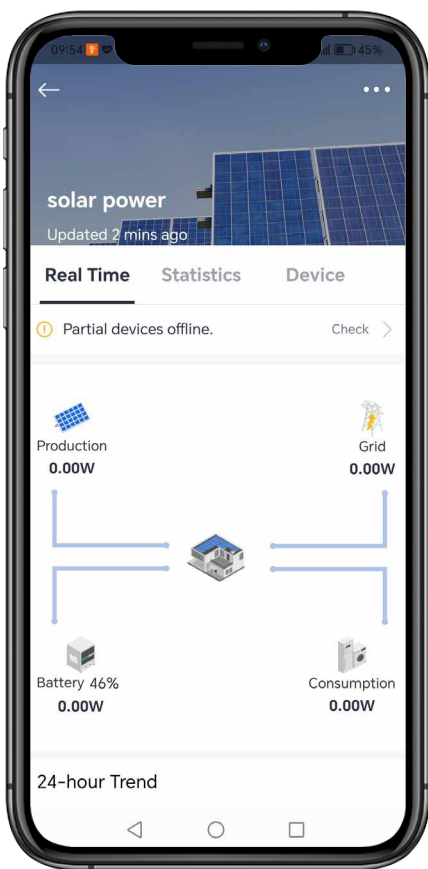

In the "Statistics" interface, we can also see the data information of system operation, as shown in the following figure.

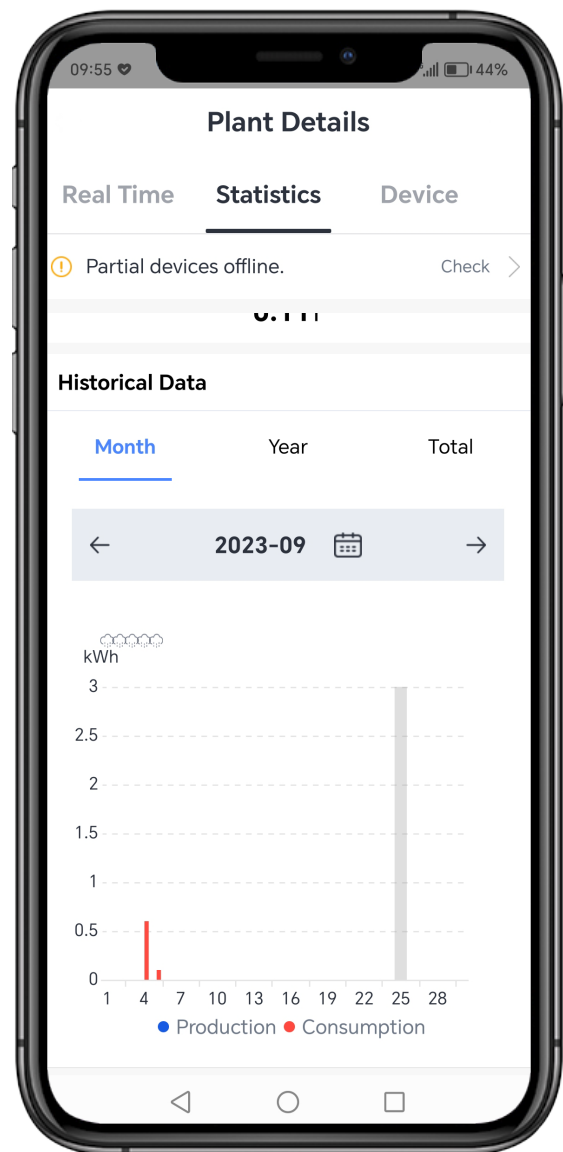
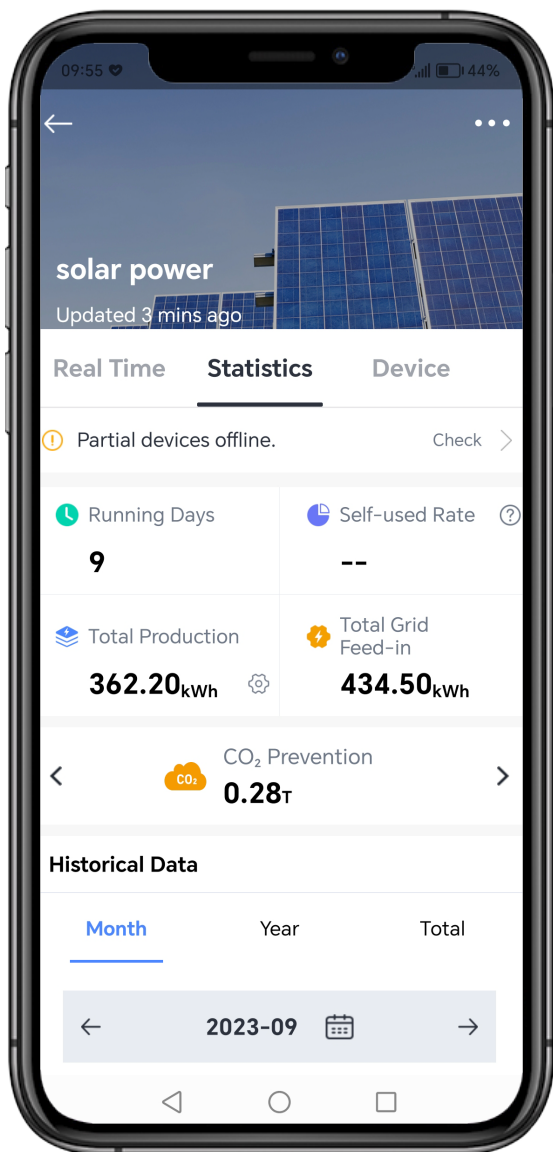

If you want to know more detailed information, please refer to the user manual on the APP, as shown below:

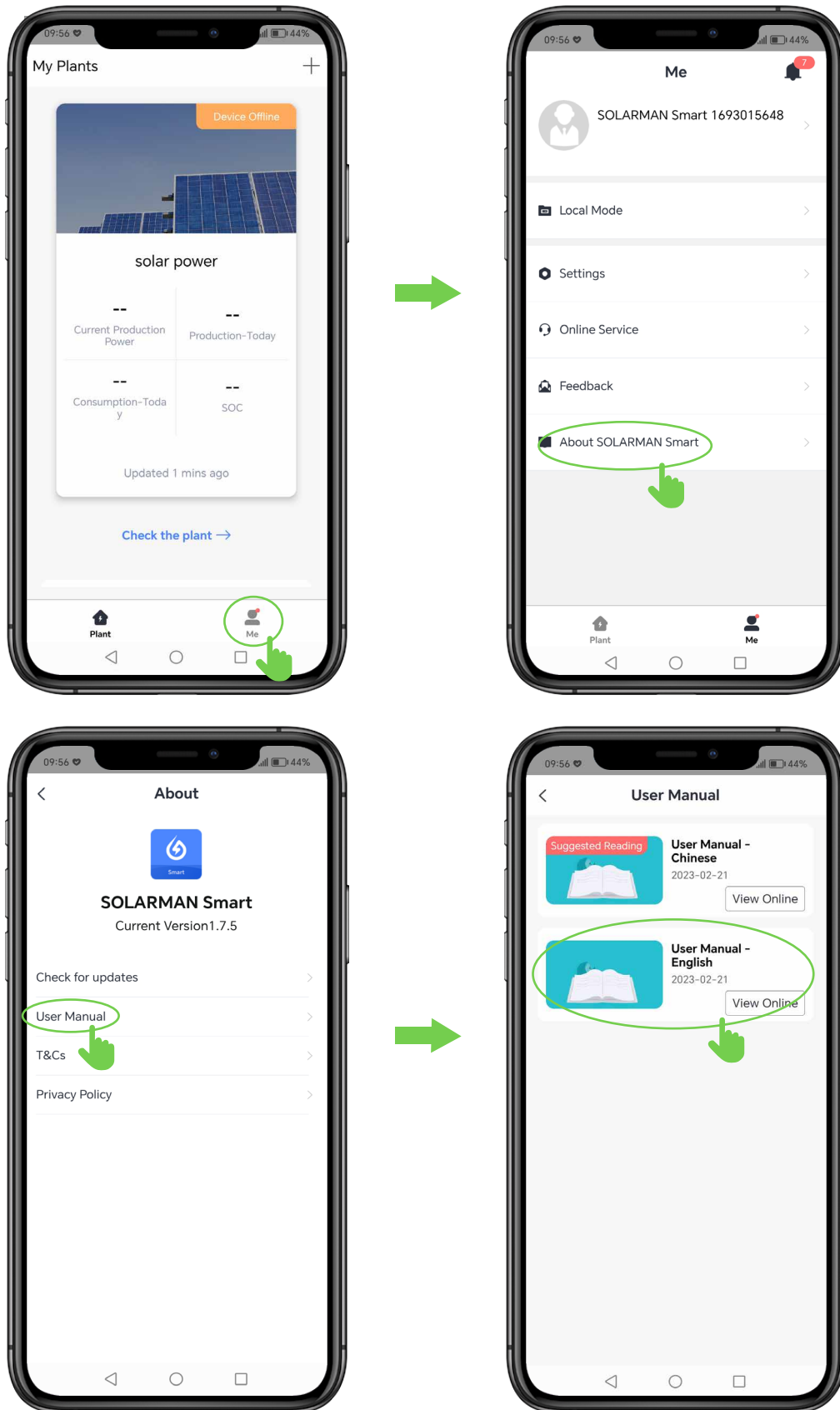

# Common Settings



Please learn the function of the relevant settings before modifying the settings. Please do not change them randomly. Otherwise system errors will be caused.

Click **Device** to enter the following interface, click **Remote Control**

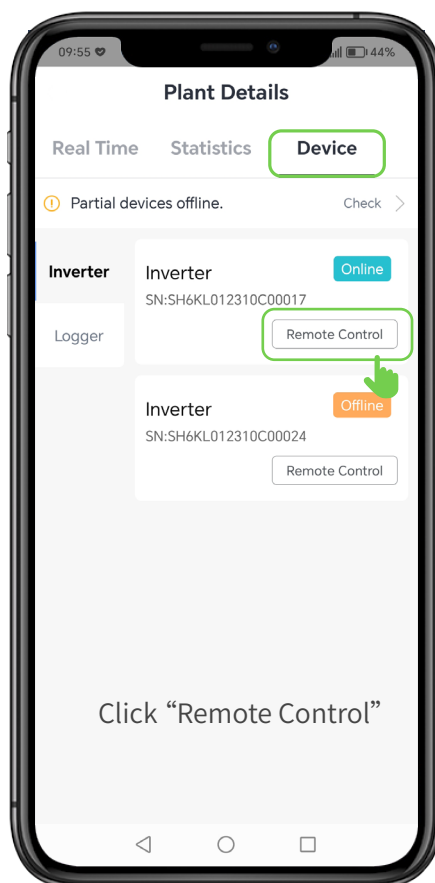

# Number Time Periods

After setting all the charging and discharging periods, we can set the "Number Time periods" to activate the set charging and discharging periods.

For example, a total of 5 Charge and Discharge periods are set. If the number "2" is entered in "Number Time Periods", the first two of the priority periods will be activated.

Generally, priority periods are set from priority period 1 in numerical order (For example, period 1, period 2, period 3...). The Charge and Discharge periods are also activated in sequence (For example, time period 1, time period 2, time period 3, time period 4 and time period 5 are set. If number "2" is entered in Number Time Periods, the time period 1 and 2 will be activated.).

After the setup is complete, you need to click the "Send Command" button to activate the instruction.

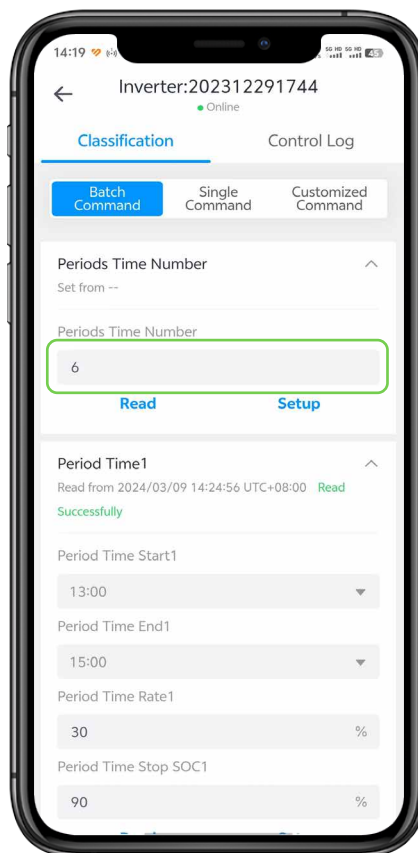

Entering "6" indicates that the first six periods are activated

**NOTE:** When the "Number Time Periods" is entered as "0" and activated, the preset priority periods will be cleared and need to be reset.

# Period Time

There are 20 priority periods in the APP, and each period has three setting options.

- **Period N Start time:** The value ranges from 0:00 to 23:59.
- **Period N End time:** The value ranges from 0:00 to 23:59.
- **Period N charge and discharge power:** The value ranges from "-100 to 100%". When a negative value between -100 and 0 is set, it indicates that the system is discharging at that power. When a positive value between 0 and 100 is set, it indicates that the system is charging at that power.
- **Period time stop SOC:** The value ranges from 0-100%. It indicates the battery will charge or discharge until it reaches the cut-off capacity you set at the set time period.
- **Period N stop SOC :** The cut-off SOC for charging and discharging.

1. If you set multiple priority periods, the number of effective periods depends on the set Number Time Periods.
2. At the same time, the battery will charge or discharge in the effective priority period according to the set Time Periods rather than the serial number of the set priority period.

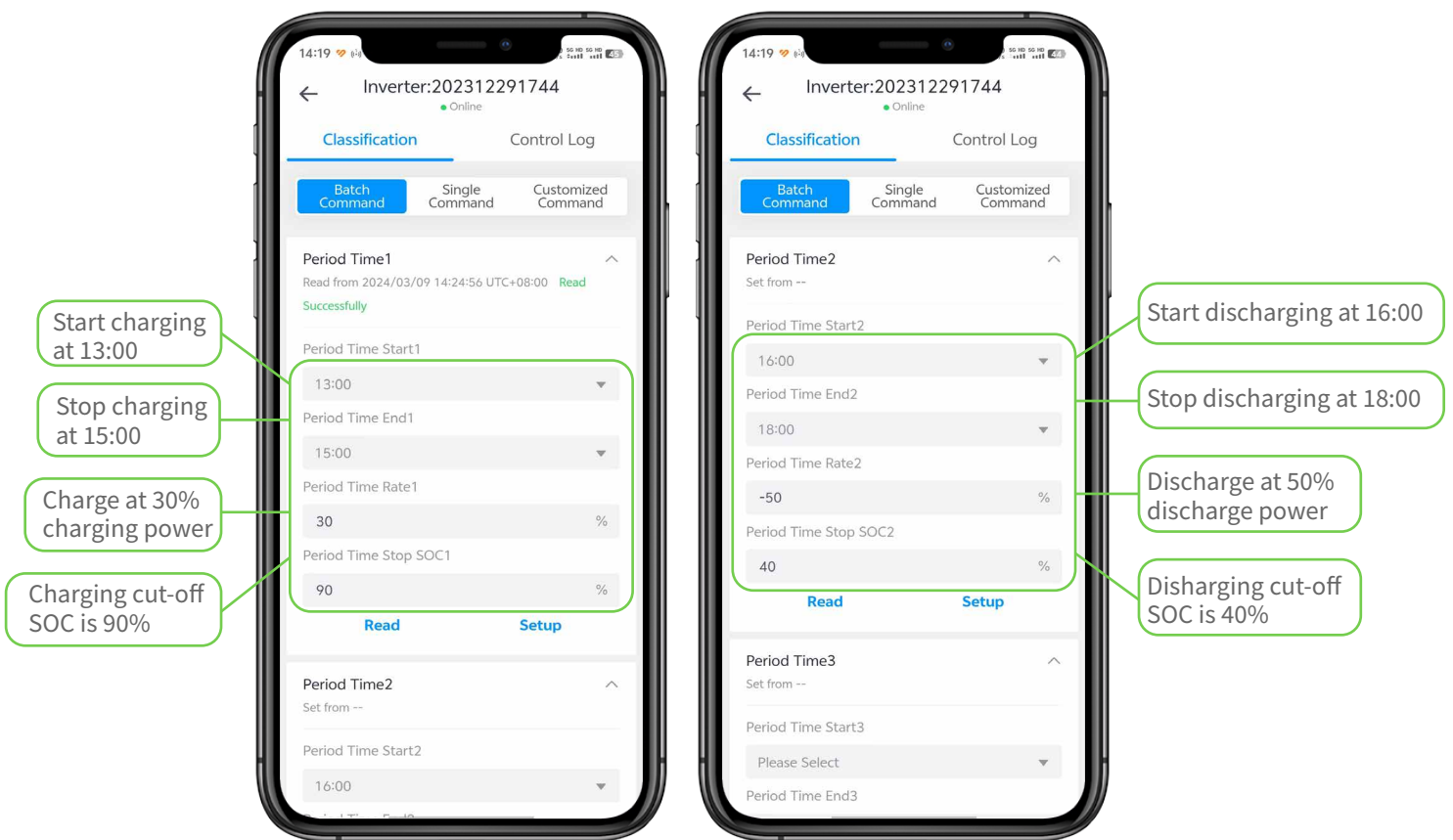

## NOTE:

- ① After setting the priority period, you need to set the number of charge and discharge periods immediately to activate the preset priority period.
- ② At the same time, you can not set two overlapping periods. For example, if you set time range from 0:00 to 01:00 and from 01:00 to 02:00, the time 01:00 in the first period will coincide with 01:00 in the second period. You need to set the priority time range from 0:00 to 01:00 and from 01:01 to 02:00.
- ③ When the inverter is suddenly disconnected or when the grid and battery are all disconnected, the set priority periods will be saved automatically.

# Battery Charge/Discharge Setting

- This is battery setting which will be performed in the load priority mode. (For details on priority, please refer to Prioritization Mode in Common Settings.)
- **Load First Charge Rate&Load First Discharge Rate** refers to the charging and discharging power of the battery in load priority mode.
- **Load First Stop SOC** indicates the battery will stop discharging when it reaches the set SOC value.
- **Charge Stop SOC** means the battery will not be charged when it reaches the set SOC value. If the PV is turned on, the battery will be charged by the PV and the grid together.
- **Grid First Stop SOC** means the battery will stop discharging to the grid when it reaches the set SOC value.

The battery is charged/discharged at a set power in load priority mode.

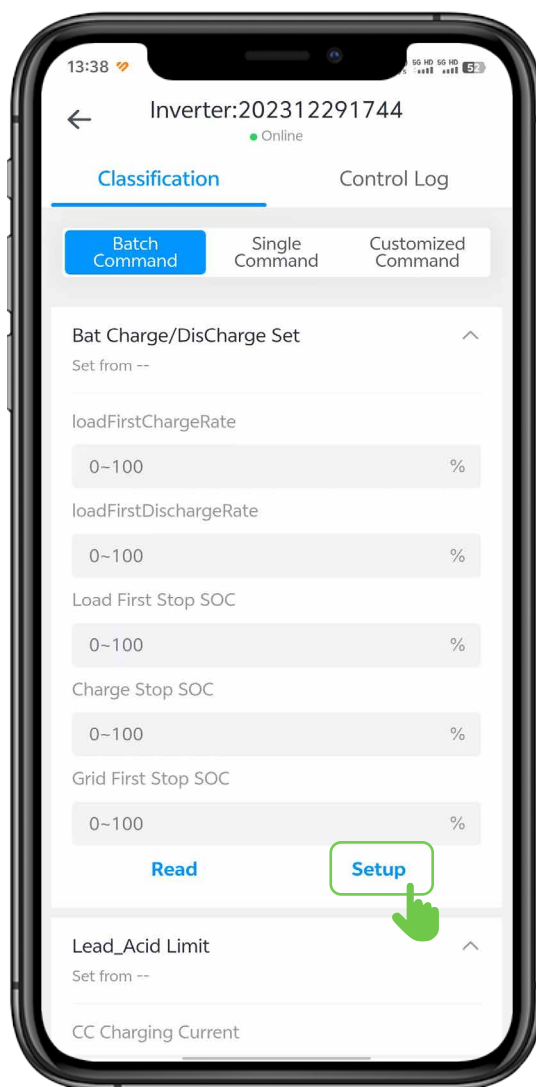

\***SOC**: State of Charge, refers to the available state of charge remaining in the battery.

# AC Charge Enable

When AC Charging is enabled, it will allow the grid to charge the batteries.

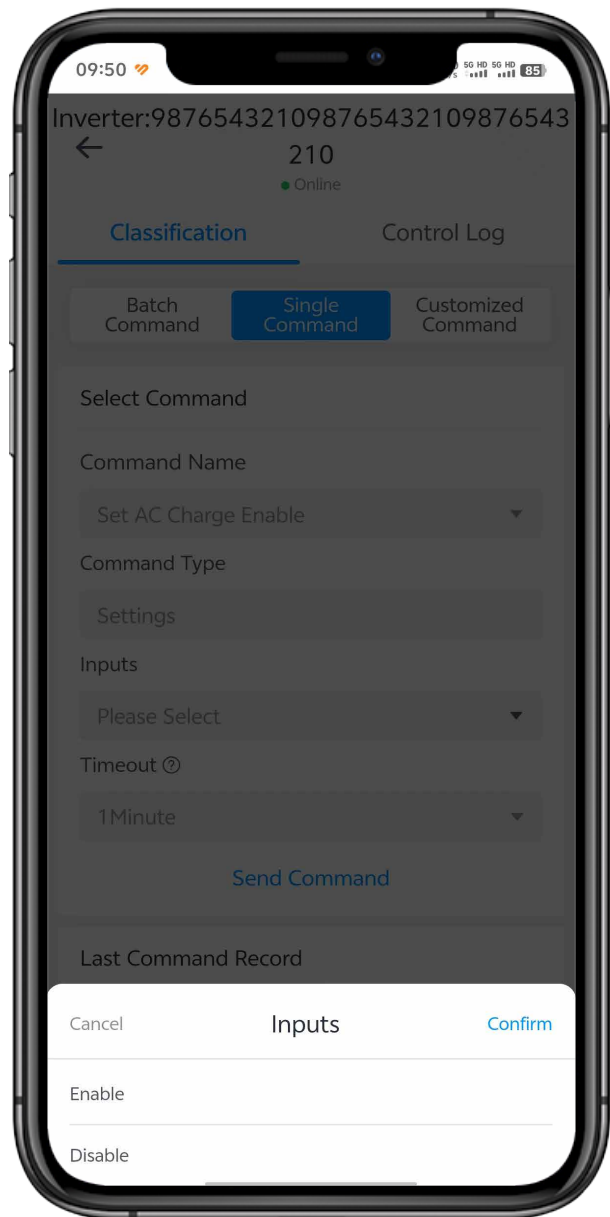
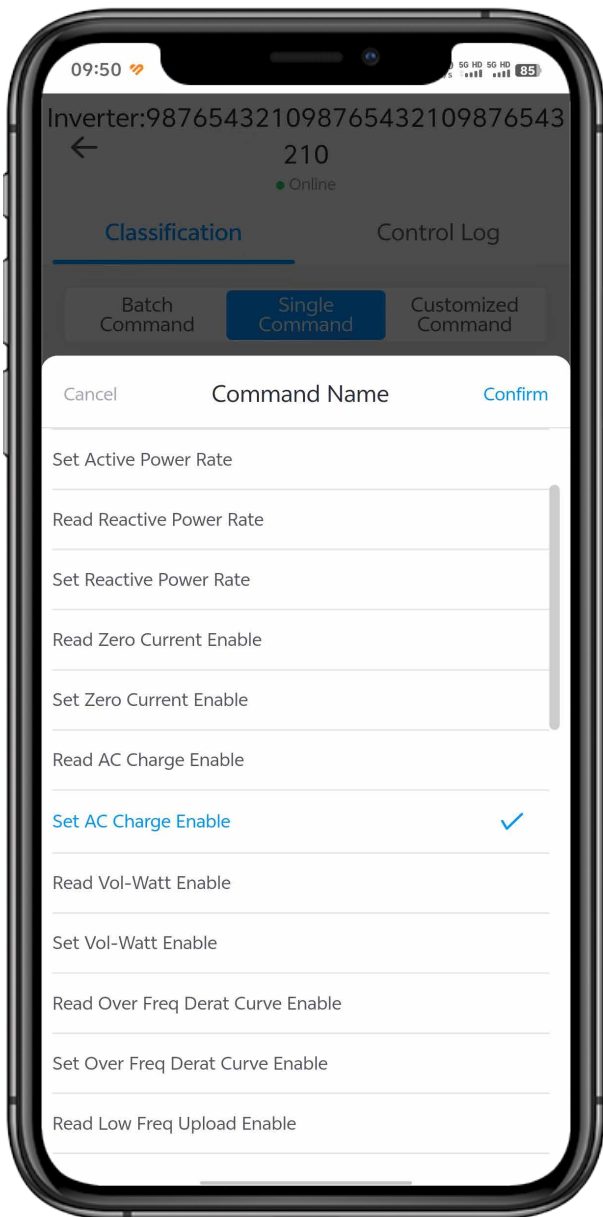

# Set ON/OFF Enable

This is the device switch. The device will enter standby mode when plugged. The device will run when the switch is turned on.

Click **Single Command** → **Select Command** → **Command Name** , select **Set ON/OFF Enable** function , click **Confirm** , and click On/Off to open or close the inverter. After the setup is complete, you need to click the **Send Command** button to activate the instruction.

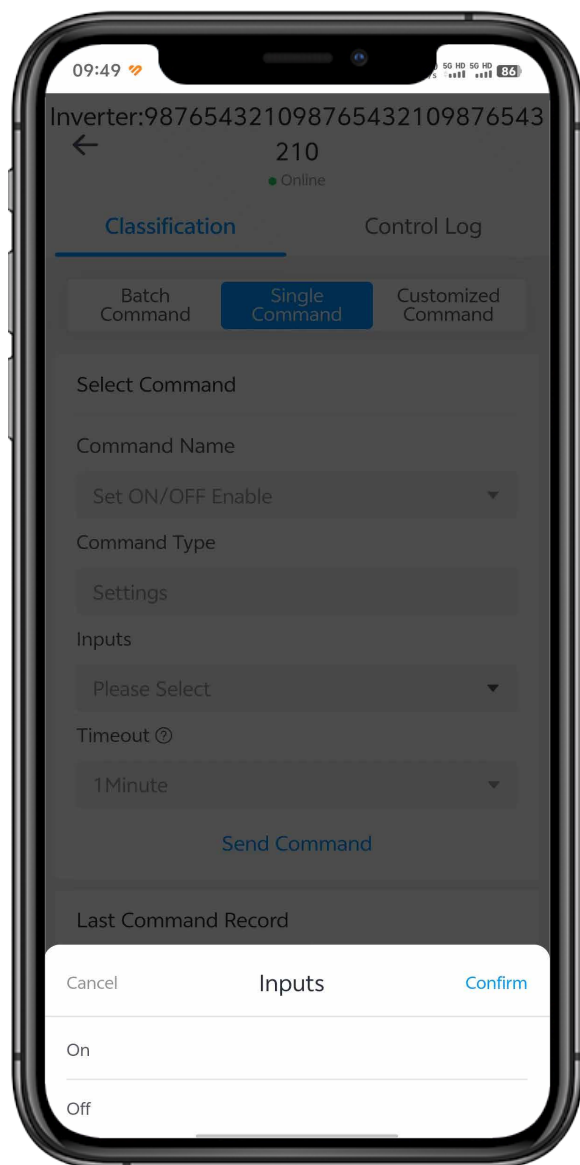
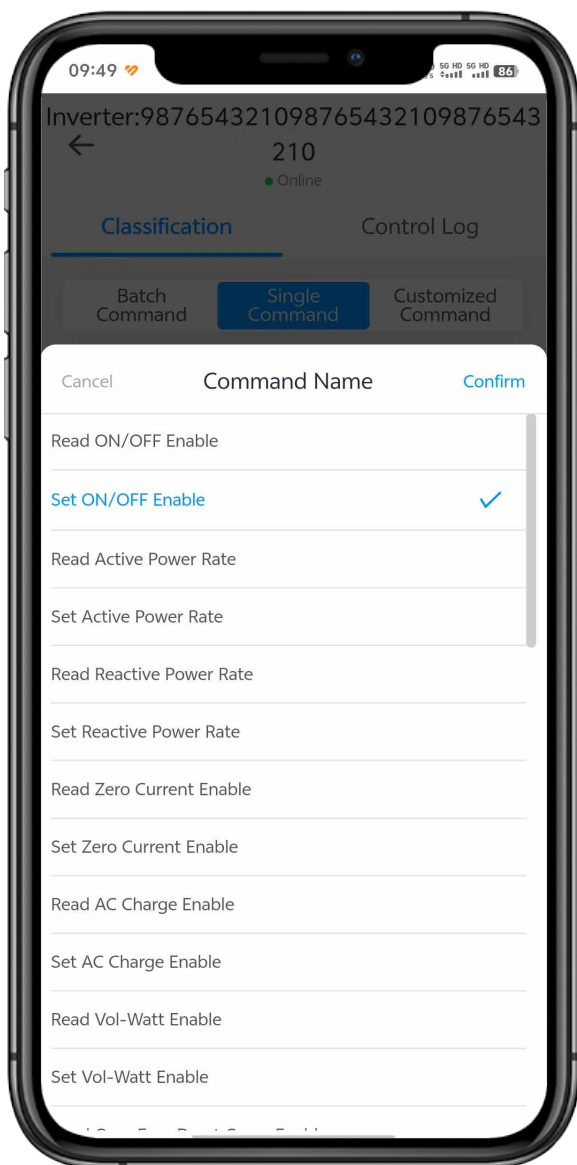

# hinen