

1. Interface Layout

Item	Description
A	SIM Card Slot
B	SD Card Slot
C	DTU Power Indicator
D	DTU Communication Indicator (With Server)
E	DTU Communication Indicator (With Microinverter)
F	DTU Alarm Indicator
G	4G Antenna
H	RS485
I	DRM Port (For Australia only)
J	Ethernet Port
K	USB Port
L	Reset Hole
M	Power Port
N	2.4G Antenna

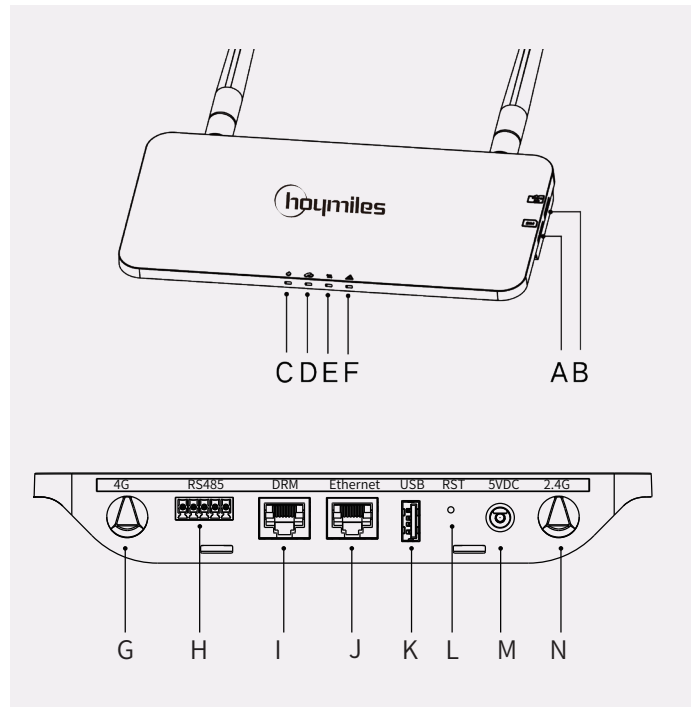

2. Preparation

A) Scan the QR code to download the S-Miles Installer App.



B) Check the box for the following items:

✓ Hoymiles DTU-Pro-C	✓ One 2.4G Antenna
✓ One 4G Antenna	✓ Adapter
✓ Bracket	✓ 5-Pin Plug
✓ SIM Card (if not pre-inserted)*	

*: If the SIM Card is pre-inserted into the device, it will not be included as a separate item in the packing list.

C) Choose the Internet connection method for DTU: 4G or Ethernet. Prepare the following items if needed:

For 4G Option:

- ✓ SIM Card (if not pre-inserted)**
- ✓ Smartphone/Tablet with S-Miles Installer App

For Ethernet Option:

- ✓ Router Ethernet Cable
- ✓ Smartphone/Tablet with S-Miles Installer App

**: If the SIM Card is pre-inserted into the device, no additional preparation is required.

3. Installation

A) Take the 2.4G antenna and 4G antenna out of the box, then screw the antennas into the 2.4G port and 4G port respectively.

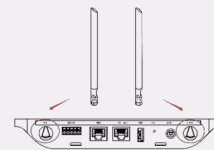

B) Insert the SIM Card into the slot, pressing until it clicks securely in place.

(If the SIM Card is already pre-inserted in the device, visually confirm that it is properly placed in the slot.)

C) Choose an installation location.

- Install on the top floor to increase signal strength.
- Install near the center of the PV array.
- Install at least 0.5 m above the ground and more than 0.8 m away from corners.

Note: Please do not install the DTU directly above metal or concrete to prevent signal interference.

D) Choose the installation method.

Option 1: Mount the DTU on the wall.

- Position the bracket on the wall.
- Use at least two M4 screw holes (one on each side) to secure the bracket in place.

Note: M4 screws are prepared by the installer.

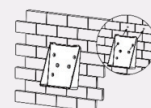

- Align the DTU with the bracket's upper buckle.

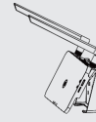

- Gently press the bottom of the DTU into the bracket's lower buckle until it clicks.
- Ensure the antennas are perpendicular to the wall.

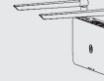

Option 2: Place the DTU on the table.

- Place the DTU on the table with antennas perpendicular to the surface.



- E) Plug in the power adapter to power the DTU.
- F) Set up with the Internet.

- If you select the Ethernet option,
 - Connect one end of a LAN cable to the house router and the other end to the DTU Ethernet port.
 - Open the Installer App on your smartphone/tablet and log in.
 - Click **O&M** icon at the bottom of the page, then choose **Network Config** and further select **Ethernet**.
- If you select the 4G option,
 - Open the Installer App on your smartphone/tablet and log in.
 - Click **O&M** icon at the bottom of the page, then choose **Network Config** and further select **4G**.

Note:

- For North American users, verify that you have selected "North American" from the Server Domain drop-down list.
- If you are using a DTU with pre-inserted SIM Card, the APN has been preconfigured as Orange.M2M.spec. However, if you have to modify the APN, you can tap on **O&M** > **Toolkit** > **Cloud Communication** > **Network Config** to access the APN setting page.

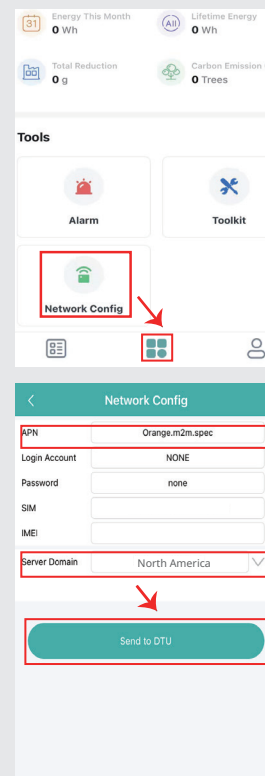
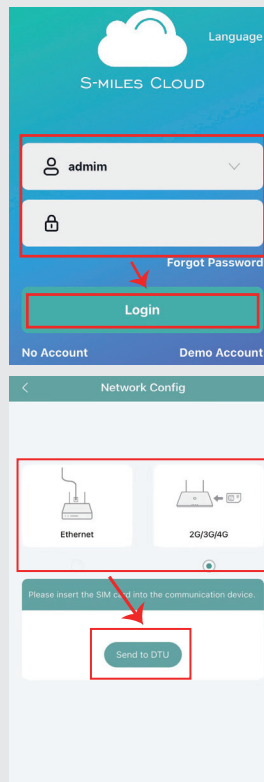

4. Completing the Installation Map

- Peel off the serial number label from the DTU and affix it to the installation map.
- Fill out the system information on the installation map as indicated.

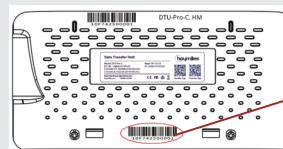

5. Online Setup

To complete the DTU installation, create an online account using the steps provided in the "Quick Installation Guide for S-Miles Online Registration".

Note: For further setup instructions on Export Management and Local Installation Assistant, please contact Hoymiles Technical Support Team at service@hoymiles.com to obtain the relevant Operation Guide.

6. Warning

Warning

- Only qualified personnel can install or replace the DTU.
- Do not attempt to repair the DTU, as it contains non-serviceable parts. In case of a breakdown, please contact your distributor for maintenance. Unauthorized opening of the DTU will void the warranty.

Product information is subject to change without notice. (Please download reference manuals at www.hoymiles.com.)